



Slat Wall with P-System



"The Zeta P2 with the Tenso connectors totally opened my eyes on how to accomplish this task, and they made it easy and fast. Being able to walk into a room and snap my slats into place and immediately see a perfect finished result was very refreshing. I am finding new ways to utilize this machine every time I have it in my hands. "

Jason Bent, Owner, Bent's Woodworking & More, Greenwood, IN



"There was really no other tool/fastener system that could accomplish the task I needed. The P system with Tenso connectors allowed me to create a beautiful prefinished slat wall using two different finishes on the back wall and slats. This method of attachment allowed me to have fast attachment of my slats, no exposed fasteners, and a crisp connection between my prefinished slats and back panel. The Tenso connectors gave me a flawless execution of my project."

Spencer Lewis, Owner, Insider Carpentry, Decatur, IL



How it works:

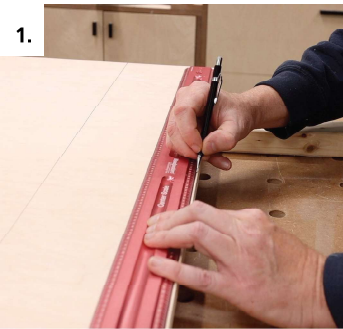

1. Determine and mark spacing for Tenso connectors

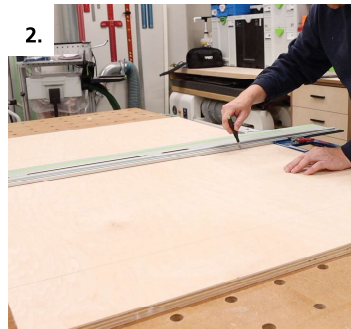

2. Determine and mark spacing for each slat based on material thickness and reveal

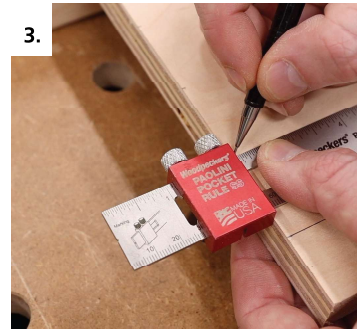

3. Extend marks for reference on top and bottom



4. Using a piece of scrap wood, cut spacers to match your reveal

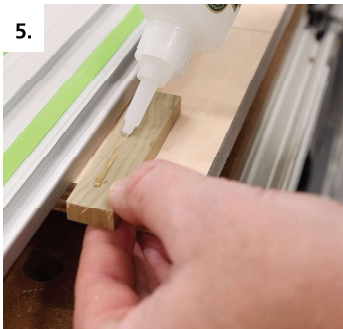

5. Connect spacers to a straight edge with hot glue near the ends of the backer material

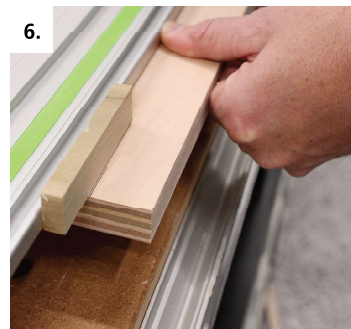

6. Align spacers with reference marks and clamp in place



7. Use the center marks for the Tenso connectors and make plunge cuts

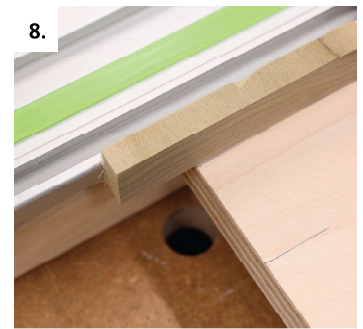

8. Unclamp and repeat at each slat location on backer sheet

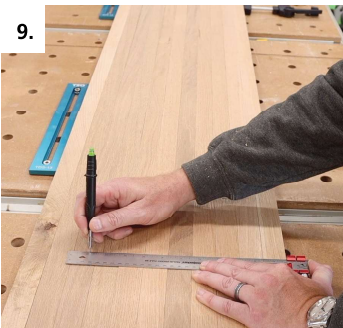

9. Mark the center line of slot locations on the slats



10. Make plunge cuts on the slats



11. Install Tenso connectors on slats and backer board



12. Snap slats into place on finished project

Lamello

P-System tools, connectors & accessories

For in-depth Lamello how-to videos, visit our Lamello Lessons YouTube channel



Zeta P2 biscuit joiner	Art. No.
In Systainer, with carbide cutter and drill jig	101402S
In Systainer, with diamond cutter and drill jig	101402DS



Zeta P2 cordless biscuit joiner, DP (diamond)	Art. No.
In Systainer, incl. 2 batteries and charger	101801SD
In Systainer, without batteries, without charger	101800SD



P-System connector assortment basic	Art. No.
Includes: 80 pairs Clamex P-14, 80 pairs Tenso P-14 incl. clip, 60 pairs Clamex P14/10 Medius, 20 pieces Bisco P-14, Tenso P-14/10 preload tool, Systainer II T-Loc incl. compartment dividers	145314



P-System connector assortment professional	Art. No.
Includes: 120 pairs Clamex P-14, 30 pairs Clamex P-14/10 Flexus, 30 pairs Clamex P-10, 80 pairs Tenso P-14 incl. clip, 30 pairs Tenso P-10 incl. clip, 20 pieces Bisco P-14, 20 pieces Bisco P-10, 80 pairs Divario P-18, Divario installation tool/drill/marking gauge, Clamex, P installation tool, Tenso P-14/10 preload tool, Sortainer T-loc	145323



Divario P-18 Starter Set	Art. No.
In Systainer3, includes: Divario P-18, 80 pairs, drill, metal marking jig and installation tool	145551



Clamex P-14	Art. No.
80 pairs	145334
300 pairs	145346
1000 pairs	145356



Clamex P-14/10 Medius	Art. No.
80 pairs	145370
300 pairs	145371



Clamex P-10	Art. No.
80 pairs	145372
300 pairs	145373
1000 pairs	145374



Clamex P-14/10 Flexus	Art. No.
80 pairs	145315
300 pairs	145316
1000 pairs	145317



Bisco P-14	Art. No.
80 pieces	145301
300 pieces	145302
1000 pieces	145303



Bisco P-10	Art. No.
80 pieces	145304
300 pieces	145305



Divario P-18	Art. No.
80 pairs	145550
300 pairs	145560
1000 pairs	145570



Tenso P-14	Art. No.
80 pairs	145415
80 pairs, with preload clip	145415S
300 pairs	145425
1000 pairs	145435



Tenso P-14 preload clip	Art. No.
300 pieces	145426
1000 pieces	145436



Tenso P-10	Art. No.
80 pairs, with preload clip	145418
300 pairs, with preload clip	145428
1000 pairs, with preload clip	145438

Your distribution partner: