



Mail Room Cubbies with P-System (Zeta P2 + CNC)



“ The Lamello Divario P-System significantly expedited the assembly process for this project. It made it easier to move the cabinet boxes around within the shop during production, streamlined delivery to the job site, and accelerated installation. This method also allows the customer the flexibility to modify slot sizes as needed or, if a shelf becomes damaged, it allows for an easy replacement of just the shelf rather than the entire cabinet, providing greater adaptability. ”

Jack Chailertphetdee, Aubin Woodworks – Bow, NH



How it works:



1. Drill 8mm holes for male halves into uprights with CNC router (or handheld jig)



2. Pre-assemble cabinet units



3. Machine the running slots on shelf edges with wing cutter on router/shaper table. Use stop blocks on fence to keep slots blind within shelf edges.

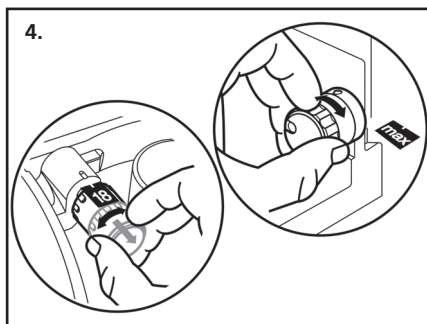

4. Set Zeta P2 to “18” depth setting for Divario P-18 slots



5. Use Zeta P2 to machine the P-System slots for the female halves



6. Install female halves into shelf edges with Divario install tool



7. Install male halves into cabinet uprights



8. Install shelves into cabinets



9. Sliding, locking, clamping connections for shelves and uprights!

Lamello

P-System tools, connectors & accessories

For in-depth Lamello how-to videos, visit our Lamello Lessons YouTube channel



Zeta P2 biscuit joiner	Art. No.
In Systainer, with carbide cutter and drill jig	101402S
In Systainer, with diamond cutter and drill jig	101402DS



Zeta P2 cordless biscuit joiner, DP (diamond)	Art. No.
In Systainer, incl. 2 batteries and charger	101801SD
In Systainer, without batteries, without charger	101800SD



P-System connector assortment basic	Art. No.
Includes: 80 pairs Clamex P-14, 80 pairs Tenso P-14 incl. clip, 60 pairs Clamex P14/10 Medius, 20 pieces Bisco P-14, Tenso P-14/10 preload tool, Systainer II T-Loc incl. compartment dividers	145314



P-System connector assortment professional	Art. No.
Includes: 120 pairs Clamex P-14, 30 pairs Clamex P-14/10 Flexus, 30 pairs Clamex P-10, 80 pairs Tenso P-14 incl. clip, 30 pairs Tenso P-10 incl. clip, 20 pieces Bisco P-14, 20 pieces Bisco P-10, 80 pairs Divario P-18, Divario installation tool/drill/marking gauge, Clamex, P installation tool, Tenso P-14/10 preload tool, Sortainer T-loc	145323



Divario P-18 Starter Set	Art. No.
In Systainer3, includes: Divario P-18, 80 pairs, drill, metal marking jig and installation tool	145551



Clamex P-14	Art. No.
80 pairs	145334
300 pairs	145346
1000 pairs	145356



Clamex P-14/10 Medius	Art. No.
80 pairs	145370
300 pairs	145371



Clamex P-10	Art. No.
80 pairs	145372
300 pairs	145373
1000 pairs	145374



Clamex P-14/10 Flexus	Art. No.
80 pairs	145315
300 pairs	145316
1000 pairs	145317



Bisco P-14	Art. No.
80 pieces	145301
300 pieces	145302
1000 pieces	145303



Bisco P-10	Art. No.
80 pieces	145304
300 pieces	145305



Divario P-18	Art. No.
80 pairs	145550
300 pairs	145560
1000 pairs	145570



Tenso P-14	Art. No.
80 pairs	145415
80 pairs, with preload clip	145415S
300 pairs	145425
1000 pairs	145435



Tenso P-14 preload clip	Art. No.
300 pieces	145426
1000 pieces	145436



Tenso P-10	Art. No.
80 pairs, with preload clip	145418
300 pairs, with preload clip	145428
1000 pairs, with preload clip	145438

Your distribution partner: